

1 Programing the emitter

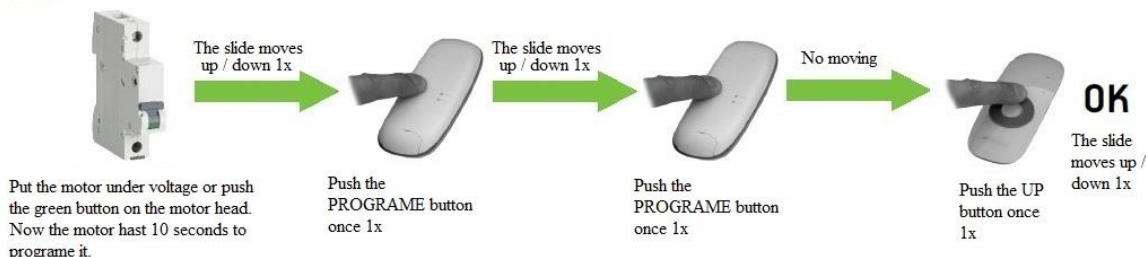

2 Change direction

Push the green button on the motor head and hold it for 6 seconds till the slide moves up / down 1x. Now we changed direction!

3 Copy the emitter (Don't need power cut off, this is the only way to learn more emitter to a motor)

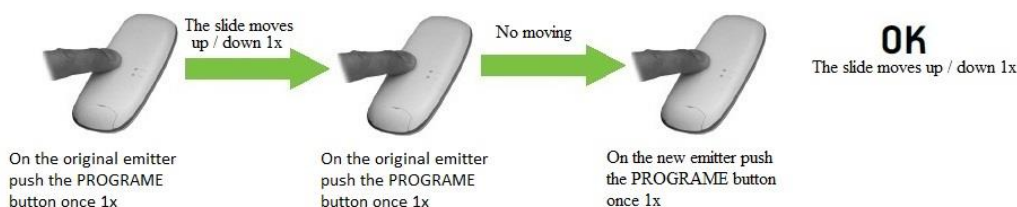

4 Erase the emitter (Don't need power cut off)

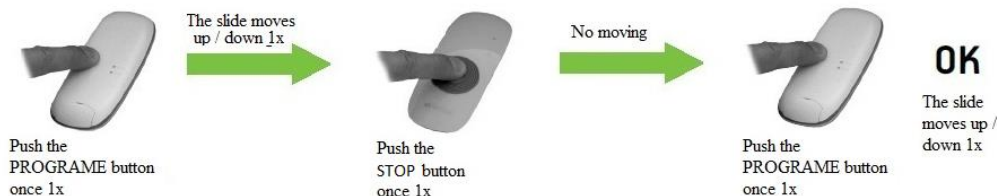

5 Step mode function on / off (Don't need power cut off)

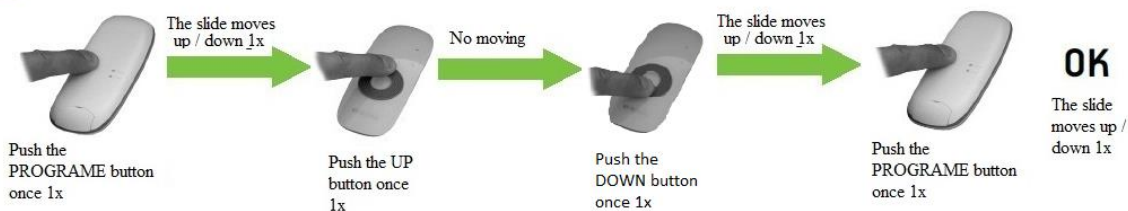

iroda:

H-1139 Budapest, Frangepán utca 79.

www.smart-home.hu | info@smart-home.hu | +36 20 287 1714

számlázási cím:

SANET-Trade Kft. | H-1139 Budapest, Petneházy utca 28.

Adószám: 14996429-2-41 | Bankszámlaszám: 10401000-50515755-88901018 K&H

SMART 35 RE10 and RE13 motors END limits, Favorite Position, Obstacle Detection

Note: Between button presses, wait for the motor to give feedback!

Limit setting (do not cut the power)

Entering programming mode:

- Press the P2 button, UP button and P2 button again.

Upper limit setting

- Start moving the shutter by pressing the UP button on the remote.
- At the desired position, press the STOP button once (movement stops).
- Now press and hold the STOP button until the motor confirms by one up/down jog, saving the upper limit (about 6 s).

Lower limit setting

- Start moving the shutter by pressing the DOWN button on the remote.
- At the desired position, press the STOP button once (movement stops).
- Now press and hold the STOP button until the motor confirms by one up/down jog, saving the lower limit (about 6 s).

With this, limit setting is complete.

If you want to RESET the end limits you have to do this method again!!!! (Entering programming mode-Upper Limit- Lower Limit)

Intermediate (favorite) position setting (do not cut the power)

- The intermediate position can only be stored after the limits have been set; to modify it later you must set the limits again.
- Move the shading to the desired intermediate/favorite position.
- Now press and hold the STOP button until the motor confirms by one up/down jog, saving the intermediate position (about 3 s).
- You can recall the intermediate position from any position by holding the STOP button for 3 seconds.

Activating the reverse rolling function (in case of obstacle detection... only reverses from the DOWN direction; in the UP direction the motor simply switches off)

Button sequence: P2 1× – DOWN 1× – DOWN 1× (the motor beeps two short beeps)... activated. (Use the same sequence to deactivate: 1 short beep.)

Extra sensitive obstacle detection – 3 settings

Extra sensitive obstacle detection – 3 settings:

- 1. This is the default state!
If needed, it can be recalled with the following button sequence: P2 1× – STOP 1× – DOWN 1× (1× down/up movement at the end).
Within 20 cm of the upper and lower limits, the obstacle is not detected; only in between these zones is the sensitivity extra high.
- 2. Press the buttons P2 1× – STOP 1× – DOWN 1× (2× down/up movement):
Within 4 cm of the upper limit, the obstacle is not detected; within 8 cm of the lower limit, the obstacle is not detected; only in between these zones is the sensitivity extra high.
- 3. Press the buttons P2 1× – STOP 1× – DOWN 1× (3× down/up movement):
Extra sensitive obstacle detection is inactive over the full height.
(Obstacle detection still works together with the reverse rolling function, but only if the rigid anti-lift device tensions the curtain inside the box.)

Connecting and operating a doorbell switch (optional, 2 wires, 1 button press, etc.)

- From the motor's cables, connect the black and white wires to a DOORBELL switch. In this way, a remote-controlled motor can also be operated locally by a pushbutton.
- A Venetian blind pushbutton, a 3- position switch and/or a 2- direction switch is not recommended for operation!